



model **SP19**  
Eyewash Head

## FEATURES & BENEFITS

---

## OPTIONS

---

For more information, visit [www.hawesco.com](http://www.hawesco.com) or call (888) 640-4297.



## SPECIFICATIONS

---

Model SP19 is a ABS plastic eyewash head with tripod anchor, 8-32 stainless steel socket head cap screw and rubber gasket.

## APPLICATIONS

---

MODEL 7500 EYEWASH  
ARM SHOWN FOR  
REFERENCE ONLY

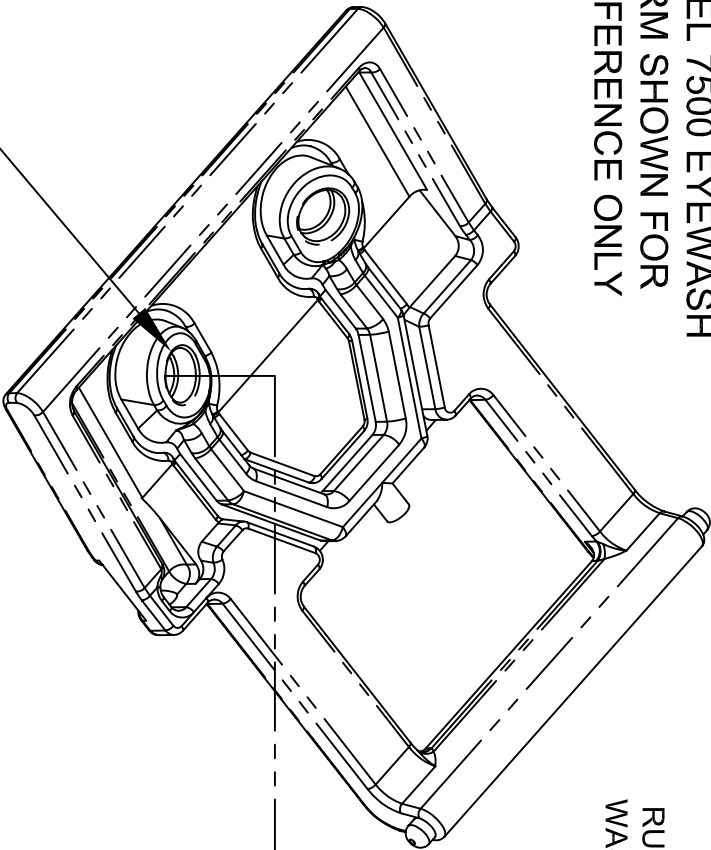

PLACE ANCHOR INTO HOLE THEN  
SCREW ON EYEWASH HEAD USING  
1/8" ALLEN WRENCH (BE SURE  
FOAM IS IN PLACE).

SOCKET HEAD SCREW  
8-32 UNC X 3/4"

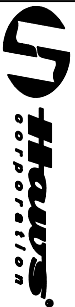
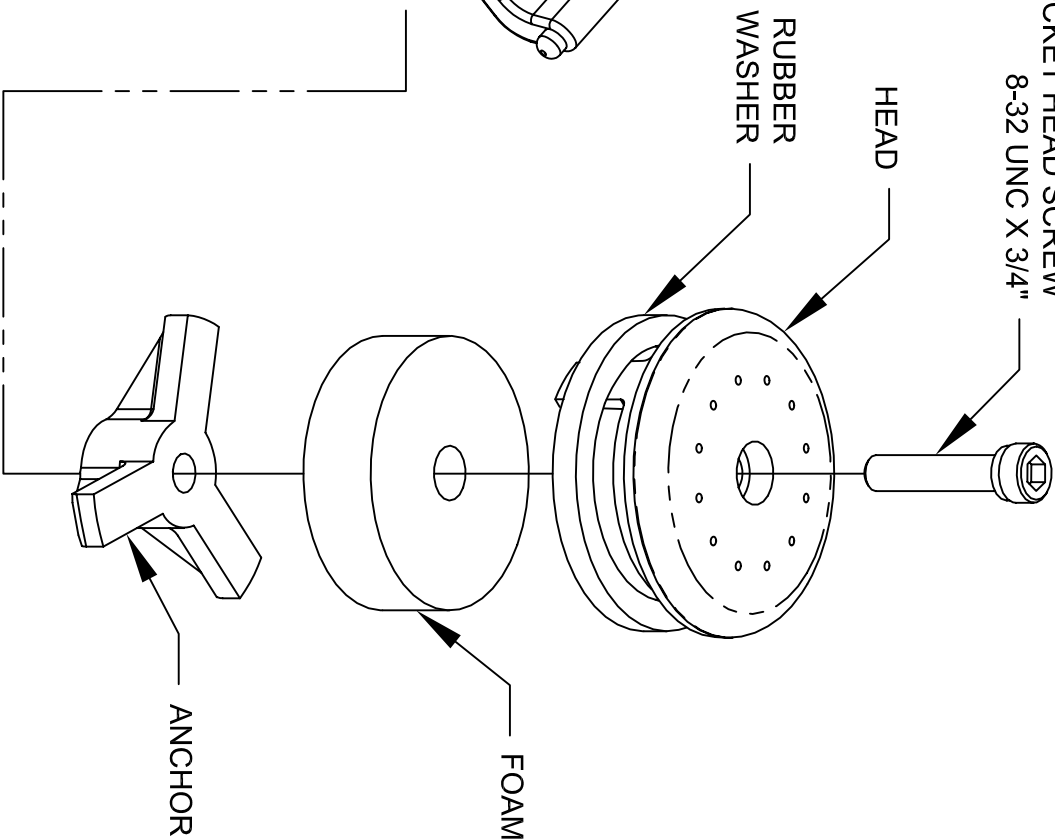

INFO FAX : 1-888-FAX-HAWS (1-888-329-4297)  
1455 Kleppe Ln, Sparks, NY, 88431  
Phone: 775-359-4712 Fax: 775-359-7424  
Haws AG, Bachweg 3, CH-3401 Burgdorf, Switzerland  
Haws Mfg Pte Ltd, 74 Sungei Kodat Loop, Singapore 729531  
e-mail: haws@hawsco.com website: www.hawsco.com

DES. NO.	2887	REVISED FOR	DATE	BY	SP19	MODEL(S):	SP19	INFO FAX DOC #	2SP19	SCALE:	1:1	DRAWING TYPE:	INSTALLATION/REWORK	SIZE:	A	Sht:	1	of	1
DATE	9/20/99	DATE	9/20/99	DATE	9/20/99	DATE	9/20/99	DATE	9/20/99	DATE	9/20/99	DATE	9/20/99	DATE	9/20/99	DATE	9/20/99	DATE	9/20/99
DATE	9/20/99	DATE	9/20/99	DATE	9/20/99	DATE	9/20/99	DATE	9/20/99	DATE	9/20/99	DATE	9/20/99	DATE	9/20/99	DATE	9/20/99	DATE	9/20/99