

25	Nut and Washer	Stainless Steel AISI316
24	Gasket	Asbestos Free
23	Blank Flange	Ductile Iron
22	Bolt and Washer	Stainless Steel AISI316
21	Locking screw	Stainless Steel AISI316
20	Thrust Nut	Bronze C83600
19	Stem Collar	Stainless Steel AISI304
18	O-ring	NBR
17	Lock Screw	Stainless Steel AISI304
16	Disc Core	High Strength Yellow Brass C86500 to ASTM B58
15	Disc Vulcanized	NBR
14	5" Storz Cap	Bronze C83600
13	Cap O-ring	NBR
12	Nozzle	Hose = Copper Alloy C99500 5" Storz =Copper Alloy C84400
11	Outlet O-ring	NBR
10	O-ring	NBR/EPDM
9	Cap attachment	Galvanize Steel
8	Stem	Copper Alloy, ASTM B98 C65500
7	Stem seal O-ring	NBR
6	Dummy nut	Bronze C83600
5	Dummy nut screw	Stainless Steel, AISI316
4	O-ring	NBR
3	Locking screw	Stainless Steel, AISI316
2	Stem nut	Copper Alloy, ASTM B62 C92200
1	Body	Ductile Iron
Pos. Detail		Material

1. Removeable outlets, stem nut and stem seals.
2. All parts interchangeable including 4"/4 1/2"/5" outlets.
3. Available with traffic section or break away check valve. both with breakable Flange.
4. Coating FBE Red inside and outside with top layer of FBP Red outside.
5. Designed to AWWA C503
6. 6" inlet to AWWA (6 holes)
7. Hydraulic test for body and seat 2 x RWP (200psi) = 400psi

View A rotated 45° (1:1)

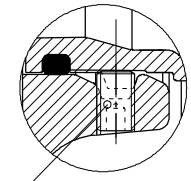

View A rotated 45° without lock screw (1:1)

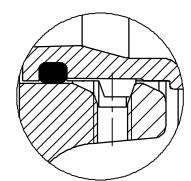

Drawing number: 24-156-10
 Drawing rev. 01
 Drawing date 26/07/2016-MMH
 Replace for

Drawing title:
 Wet Barrel Fire Hydrant 2 x 2 1/2" &
 1x 5" Storz GA Drawing

